

VARIABLE SPEED MICROCENTRIFUGE



GYRO PLUS MANUAL



FEATURES

- Variable speed up to 12,000 RPM
- Compact footprint
- Interchangeable rotors
 - 6 x 1.5 ml microtubes
 - 16 x 0.2 ml PCR tubes (strip format)
 - 6 adapters for 0.2 ml tubes
- Automatic safety stop
- LED display
- Universal voltage
- One year warranty

OPERATION

- 1** — Set the power switch to OFF, then plug in the power cable to the centrifuge and the outlet.
- 2** — Press the OPEN button to open the cover. The cover should pop open.
- 3** — Insert tubes. The location and weight of the tubes in the rotor should be balanced across the rotor.
- 4** — Close the cover until you hear a 'click'. Confirm that the cover is locked.
- 5** — Switch the centrifuge on using the ON/OFF switch on the front left of the panel. The LED display will turn on and display a 1 . The unit is set to 1,000 RPM. Press the arrows ▼▲ to select your desired speed. 12,000 RPM will be displayed as a 12 . Speed can be adjusted only if the cover is closed.
- 6** — Press the Start/Stop button to start the centrifuge.
- 7** — Press the Start/Stop button again to stop the centrifuge.
- 8** — Press the OPEN button to open the cover.

Note: Pressing the OPEN button while the centrifuge is spinning will stop the rotor from turning and open the cover at the same time.

CHANGING THE ROTOR

Use the supplied Allen wrench to remove the set screw located at the base of the rotor. Pull up the rotor and replace it with a new one. Place the set screw in the new rotor and screw until tight. Do not over tighten.

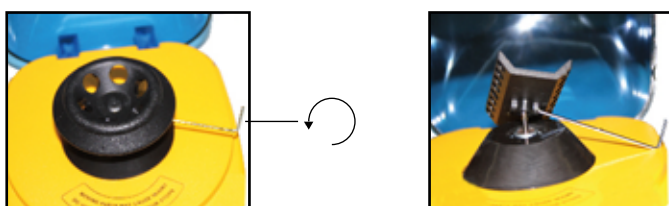

SUPPLIED ROTORS

ROTOR #1



ROTOR #2



RPM to RCF (g) CONVERSION TABLE

Speed (RPM)	RCF Rotor #1 (g)	RCF Rotor #2 (g)
1000	48	26
2000	190	100
3000	430	230
4000	770	400
5000	1200	600
6000	1700	900
7000	2350	1300
8000	3100	1600
9000	3900	2100
10000	4800	2600
11000	5800	3100
12000	6900	3700
Rotor	6 x 2 ml 6 x 1.5 ml 6 x 0.5 ml 6 x 0.2 ml	2 x 8 x 0.2 ml

IMPORTANT NOTES

- Do not touch the rotor until it comes to a complete stop.
- Routinely check that the set screw at the base of the rotor is screwed in tightly.
- Do not move the centrifuge while it is running.
- Solvents and flammable objects should not be placed next to the machine.
- Do not use explosive, corrosive or flammable materials in the centrifuge.
- Wear personal protective equipment while operating the centrifuge, including gloves and goggles.
- Do not force tubes into the rotor.

SPECIFICATIONS

- Model: Gyro Plus
- Catalog number: QP-1800-02
- Speed range: 1,000 to 12,000 RPM
- Noise level: <60 dB
- Dimensions: 18 x 15 x 13 cm
- Weight: 1 kg
- Voltage: AC 85-240 V, 50/60 Hz

